

N89C/N89C-HQ

COIL-FED PNEUMATIC FRAMING NAILER

CLAVADORA NEUMÁTICA ALIMENTADA POR ROLLO

CLOUEUR PNEUMATIQUE À ENROULEMENT

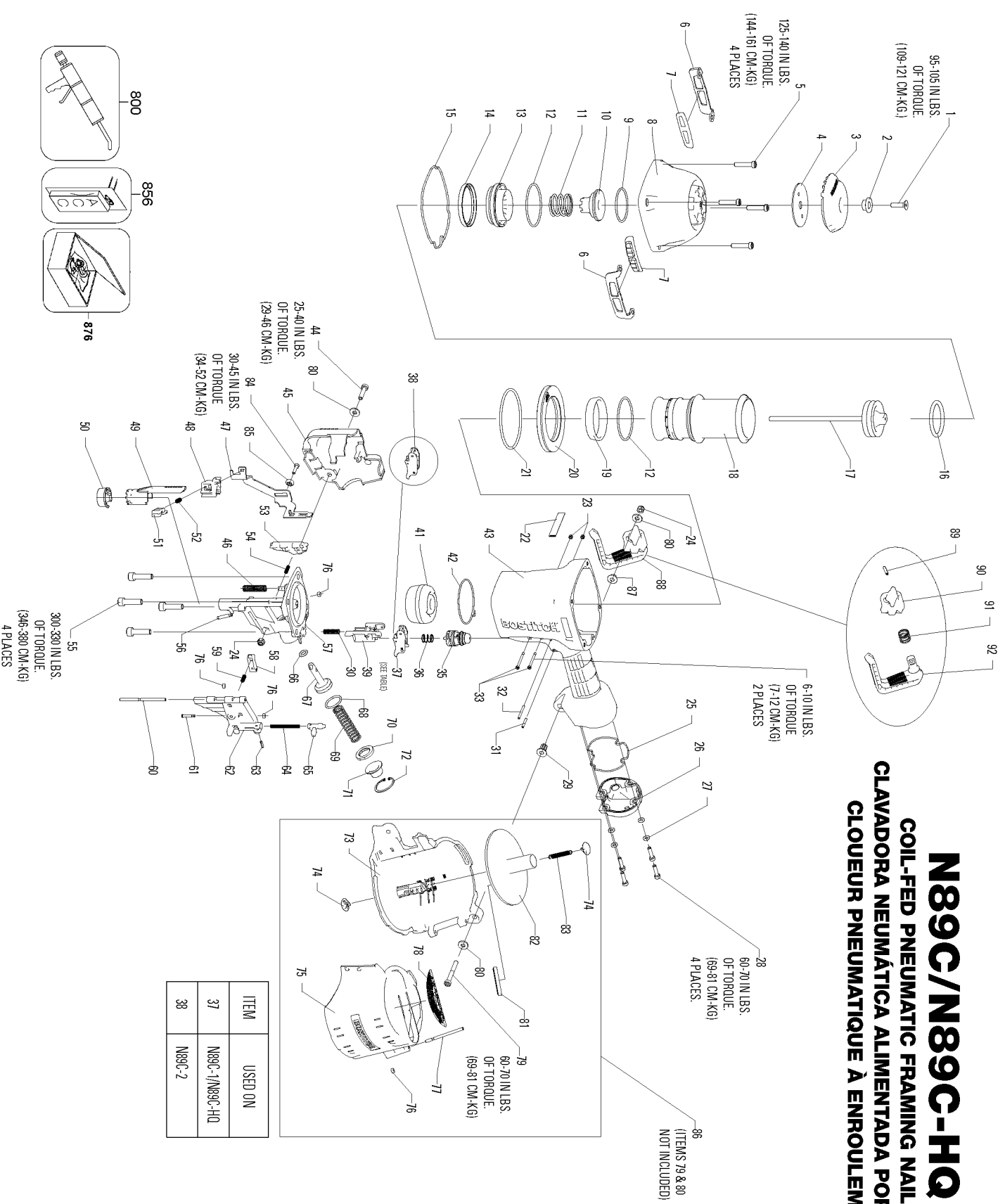

ITEM	USED ON
37	N89C-1/N89C-HQ
38	N89C-2

Parts List for N89C-HQ Type 0

Item Number	Part Number	Description	Qty Required
1	MSF6100-25	SCREW-SFHCS-M6X1.00X	1
2	163859	BUSHING-EXHAUST DEFL	1
3	163818	DEFLECTOR-EXHAUST	1
4	163830	PLATE-CAP	1
5	MSC6100-30	SCREW-SHCS-M6X1.00X3	4
6	163827	PLATE-WEAR	1
7	149819	WEAR GUIDE	1
8	163848	FRAME CAP-MACHINING	1
9	105814	O-RING-1.929X.098	1
10	163820	BUMPER-HEAD VALVE	1
11	163844	SPRING-HEAD VALVE	1
12	163822	O-RING-2.487X.103XNB	1
13	163821	LOWER BODY-HEAD VALV	1
14	163823	SEAL-HEAD VALVE	1
15	163845	SEAL-FRAME/CAP	1
16	851606-S	O-RING-1.850X.210	1
17	163816	ASSEMBLY-PISTON/DRIV	1
18	163824	SLEEVE-CYLINDER	1
19	175520	SEAL-CHECK	1
20	163855	RING-CYLINDER SLEEVE	1
21	108718	O-RING-3.484X.139	1
22	163881	LABEL-N89C	1
23	MHE3050-100	NUT-NYLON M3X.50	1
24	MHE6100-100	NUT-ESN M6X1	1
25	163856	SEAL-END CAP	1
26	163843	END CAP-PAINT	1
27	T50118	WASHER-PLAIN	1

COPYRIGHT© 2005. All Rights Reserved.

Parts list, pricing, and availability subject to change. Please visit www.dewaltservicenet.com for current parts information.

Parts List for N89C-HQ Type 0

Item Number	Part Number	Description	Qty Required
28	MSC5080-20	SCREW-SOC HD. CAP M5	4
29	123859	BUSHING-FLANGED ISOL	1
30	166781	SPRING-UPPER TRIP	1
31	MPP030020	PIN-SPIRAL M3X20MM	1
32	100298	PIN-SPIRAL M3X30	2
33	108562	SCREW-TRIGGER PIVOT	2
35	TVA6	KIT-TRIGGER VALVE	1
36	100387	SPRING-COMPRESSION	1
37	CNTK5	KIT-CONTACT TRIP CON	1
38	SEQ7	KIT-SEQUENTIAL TRIP	1
39	163883	GUIDE-ARM	1
41	107231	BUMPER-DRIVE	1
42	163884	SEAL-NOSE	1
43	171127	FRAME-OVERMOLD	1
44	MSC6100-25	SCREW-SHCS-M6X1.00X2	1
45	166766	COVER-TRIP	1
46	116970	SPRING-CONTACT ARM	1
47	163908	ARM-UPPER CONTACT	1
48	163906	CASTING-HOUSING CONT	1
49	163907	ARM-LOWER CONTACT	1
50	166765	FOOT-TRIP-N89C	1
51	108225	CASTING-PLUNGER	1
52	115230	SPRING-HOUSING	1
53	185961	PAWL-FEED-MACHINING-	1
54	166774	SPRING-FEED PAWL	1
55	MSC8125-30	SCREW-SHCS M8X30	4
56	166787	PIN-FEED PAWL	1

COPYRIGHT© 2005. All Rights Reserved.

Parts list, pricing, and availability subject to change. Please visit www.dewaltservicenet.com for current parts information.

Parts List for N89C-HQ Type 0

Item Number	Part Number	Description	Qty Required
57	185894	NOSE-MACHINING-HQ	1
58	N70149	PAWL CHECK	1
59	854011	COMPRESSION SPRING	1
60	N80125	PIN-SPECIAL	1
61	N70140	PIN-SPECIAL(STEP)	1
62	185898	DOOR-MACHINING-HQ	1
63	MPG030012	PIN SPRING	1
64	854013	SPRING,CMPRSN.	1
65	N70150	LATCH DOOR	1
66	88999	O-RING	1
67	163894	PISTON-FEED	1
68	87112	O-RING	1
69	163930	SPRING-FEED PISTON	1
70	163897	STOP-FEED PISTON	1
71	163895	COLLAR-SPRING	1
72	163896	RETAINING RING-INCH	1
73	163892	PLATFORM-CANISTER-N8	1
74	149910	CAP-NAIL TRAY	1
75	163910-S	BOSTITCH COVER	1
76	854004	WASHER-RUBBER-7	1
77	166771	PIN-CANISTER COVER	1
78	165358	LABEL-WARNING-PALLET	1
79	MSC6100-50	SCREW-SHSC-M6X1.00X5	1
80	MPW6.2	WASHER.SPECIAL	1
81	120927	LABEL-SENSOR SMALL (1
82	180545	OVERMOLD-TRAY	1
83	166768	SPRING-EXTENSION - C	1

COPYRIGHT© 2005. All Rights Reserved.

Parts list, pricing, and availability subject to change. Please visit www.dewaltservicenet.com for current parts information.

Parts List for N89C-HQ Type 0

Item Number	Part Number	Description	Qty Required
84	MSC4070-16	SCREW-SHCS-M4X0.7X16	1
85	163876	BUSHING-UPPER CONTAC	1
86	166807	ASSEMBLY-CANISTER	1
87	171342	WASHER-UTILITY HOOK	1
88	171354	ASSEMBLY-UTILITY HOO	1
89	UB3811.2	PIN- SPIROL - 5/32X3	1
90	171340	MOUNT-UTILITY HOOK	1
91	171341	SPRING-UTILITY HOOK	1
92	171339	HOOK-UTILITY	1
800	100653	LUBE (2CC)	1
800	100679	LUBE (1LB.CAN)	1

COPYRIGHT© 2005. All Rights Reserved.

Parts list, pricing, and availability subject to change. Please visit www.dewaltservicenet.com for current parts information.